

INDUCTEE INFORMATION

- 1A OR 1B - LATHE INDUCTION
- 2A - BRIDGEPORT INDUCTION
- 2B - SLOTTER INDUCTION

OWN MATERIALS TO BE SUPPLIED:

- 1A & 1B - 100MM X 30MM Ø ROUND BAR
- 2A - 50MM X 30MM SQUARE BAR
- 2B - 50MM X 50MM X 10MM RECTANGULAR BAR

EN3B (AKA 070M20) MILD STEEL

OR
1100 ALUMINIUM / 6061 ALUMINIUM

STRONGLY RECOMMENDED

£10.00 FEE PER INDUCTION PAYABLE TO THE HACKSPACE

£10.00 FEE TO INDUCTOR IS NORMAL, BUT MAY BE WAIVED AT THEIR DISCRETION

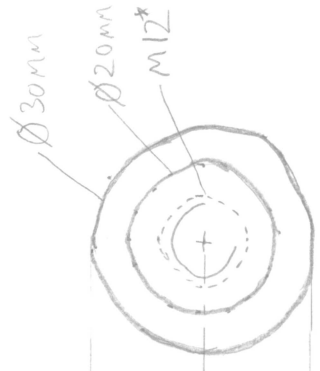

1A BASE - MACHINE JACK

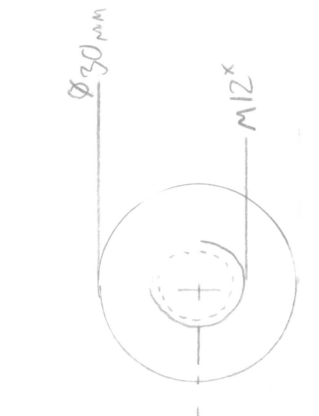

1B TOP - MACHINE JACK

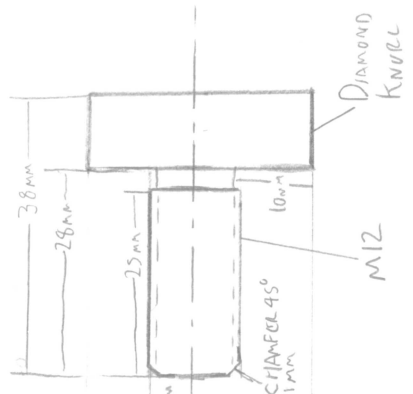
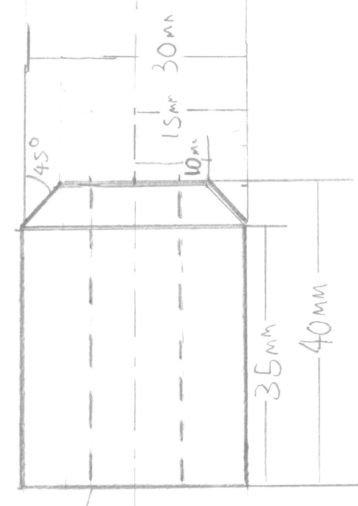

2A BASE - VBLOCK

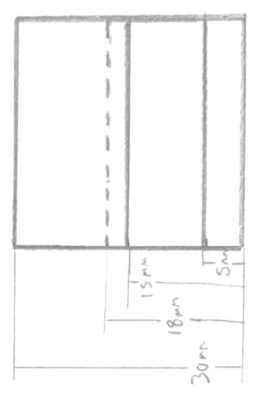
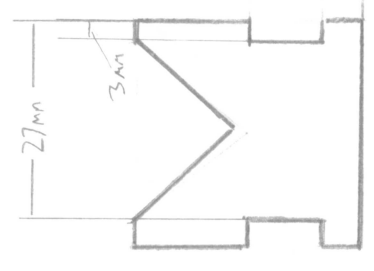
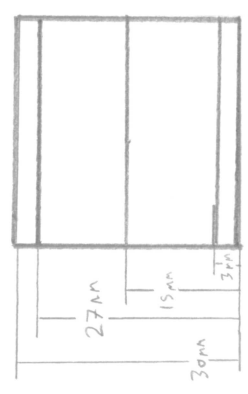

2B TOP - VBLOCK

NOTES

- * M12 Hole Requires 10.5mm TAPPING DRILL ASSUMING M12X1.75.
 - EXTERNAL THREAD REQUIRES OD 12.00mm TO 11.95mm
 - ** M6 Hole Req. 5mm TAPP DRILL ASSUMING M6X1
- ALL SKETCHES 3RD ANGLE PROJECTION
DO NOT SCALE

